

# SAFETY AIR COUPLINGS

with **LOCKING & PURGING MECHANISMS**  
preventing

- ACCIDENTAL WHIP HOSE HITTING EYES & BODY
- ACCIDENTAL DISCONNECTION OF AIR

Cat. No. SC-03

*Genuine*  
**CUPLA™**

*Our trademark is your  
Guarantee of Quality!*

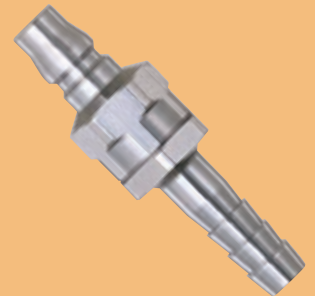

There is only one  
**GENUINE NITTO CUPLA**

**YOUR GENUINE NITTO CUPLA DISTRIBUTOR:**



With the extensive use of Compressed Air in industry today and the ever increasing focus companies have on their OH & S policies to ensure they have a safe work environment for their employees and visitors, Nitto Kohki Australia has released to the the Australian market their comprehensive range of **SAFETY CUPLAS**.

Two of the stand out products in Nitto's range are the **FULL BLOW** Cupla and the latest release, the **PVR** Cupla.

The **FULL BLOW** Cupla provides a complete safety system for compressed air outlets in 1/4", 3/8" and 1/2". In addition the release of Nitto's **PVR** Cupla extended this coverage of complete safety to larger air lines in applications requiring higher flow rates of Compressed Air for particular applications. The **PVR** Cupla has been designed as an addition to Nitto's 100 Series Cupla for Compressed Air outlets in 1/2", 3/4" and 1".

The ultimate safety features of these two ground breaking products are as follows -

## PVR CUPLA

- Connection to the PVR Cupla is made with no residual pressure which enables the user to connect the plug to the socket with ease.
- Once connection is made there is a visual window on the Cupla so the operator can identify the status of the Cupla valve, 'open' or 'shut'.
- The front blue collar of the Cupla is then easily rotated to active the Compressed Air at the same time activating the lock mechanism automatically, the visual window will now show the valve as 'open'.
- When the collar is returned to the original position the compressed air energy stored in the hose is then safely purged from the air line enabling safe disconnection with no reaction.

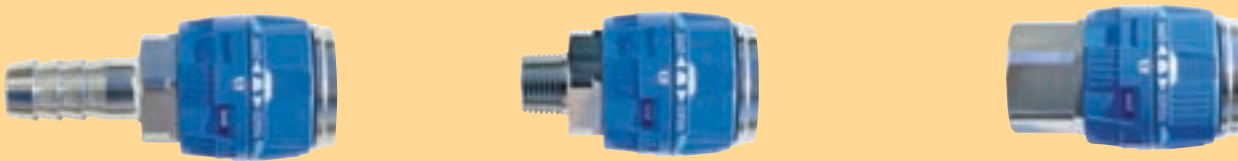

## FULL BLOW CUPLA

- Connection to the **FULL BLOW** Cupla is made with no residual pressure which enables the user to connect the plug to the socket with ease.
- Once connection is made the user has the option to lock the Cupla so the compressed air supply cannot be activated accidentally.
- With the lock disengaged, the operator simply slides the sleeve forward to apply the compressed air to the air line.
- The secondary lock function can now be activated to ensure the Cupla cannot be disconnected unexpectedly.
- With the secondary lock function off, the sleeve can then be returned to the original position. When returned, the compressed air energy stored in the hose is then safely purged from the air line enabling safe disconnection with no reaction.



The features and benefits with both the **PVR** and **FULL BLOW** Cuplas have to be seen to be believed. Contact your **Genuine Nitto Agent** to arrange a live demonstration at your premises when a Nitto representative is next in your area. Also take the opportunity to view the complete Nitto Cupla Range.

**Not all couplings are made the same,  
THERE IS ONLY ONE GENUINE NITTO CUPLA,  
demand it and reject the inferior copy couplings.**

# PVR CUPLA

Purge and Lock

## SLEEVE LOCK AND PURGE FUNCTIONS FOR SAFETY.

ELIMINATES UNPLEASANT NOISE AND REACTION ON DISCONNECTION.

### Features

- Connection and disconnection with no residual pressure.
- Incorporates purge valve for safety.
- Complete with lock mechanism.
- Full flow valve system will increase flow rate.



FOR HOSE CONNECTION (SH)

Model	Application	Weight (g)
PVR-400SH	1/2"	380
PVR-600SH	3/4"	361
PVR-800SH	1"	440

### SOCKET



FOR FEMALE THREAD CONNECTION (SM)

Model	Application	Weight (g)
PVR-400SM	1/2"	327
PVR-600SM	3/4"	345
PVR-800SM	1"	374



FOR MALE THREAD CONNECTION (SF)

Model	Application	Weight (g)
PVR-400SF	1/2"	394
PVR-600SF	3/4"	370
PVR-800SF	1"	440

# 100 SERIES HI-CUPLA

Interchanges with PVR Coupla

## FOR LARGE DIAMETER AIR CUPLAS

### Features

- An excellent general-purpose Coupla.
- Steel Coupla is suitable for air



FOR HOSE CONNECTION (PH)

Model	Application	Weight (g)
400PH	1/2"	66
600PH	3/4"	121
800PH	1"	152

### PLUG



FOR FEMALE THREAD CONNECTION (PM)

Model	Application	Weight (g)
400PM	1/2"	69
600PM	3/4"	116
800PM	1"	152



FOR MALE THREAD CONNECTION (PF)

Model	Application	Weight (g)
400PF	1/2"	82
600PF	3/4"	116
800PF	1"	190

# FULL BLOW CUPLA

Purge and Lock

### EASY CONNECTION

- Connection & disconnection with no residual pressure
- Incorporates purge valve for safety

### FULL-OPEN TYPE VALVE

- Low pressure loss
- High flow rate

### LIGHTWEIGHT

- 30% to 45% lighter than conventional Couplas

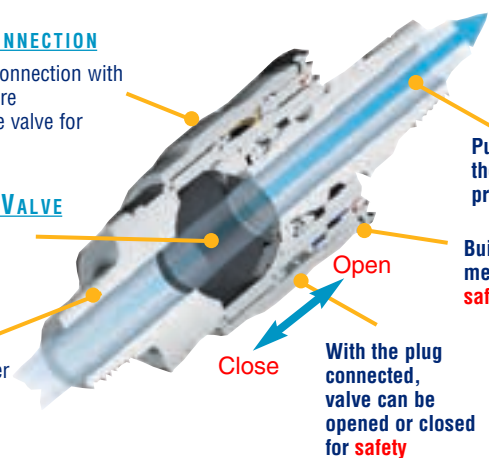

### SAFETY DESIGN -

Purge mechanism expels residual air pressure.

### FLOW RATE UP TO 40% INCREASE -

The "Full-Blow Coupla" minimizes pressure loss and offers a flow rate up to 40% higher than conventional Couplas.

### EFFECTS OF ENERGY SAVINGS -

Using Full-Blow Coupla lowers usage results in lower cost using 1000(W) pneumatic tool, a conventional Coupla requires 0.6 MPa. Switching to Full-Blow Coupla reduces needed pressure to 0.55 MPa. Required source pressure reduced by 0.05 MPa. This reduces needed air consumption by 7%, a 2.5% reduction in energy expense is also achieved.



### Specifications

Body Material	Aluminum alloy	
Working Pressure	215 PSI	1.5MPa (15 kgf/cm <sup>2</sup> )
Pressure Resistance	285 PSI	2.0MPa (20 kgf/cm <sup>2</sup> )
Flow Rate	2.93m <sup>3</sup> /min. (103 CFM)	

### Interchangeability

Hi Coupla Series plugs

### SOCKET



FOR FEMALE THREAD CONNECTION (SM)

Model	Application	Weight (g)
FBH-20SM	1/4"	71
FBH-30SM	3/8"	75
FBH-40SM	1/2"	86



FOR MALE THREAD CONNECTION (SF)

Model	Application	Weight (g)
FBH-20SF	1/4"	77
FBH-30SF	3/8"	79
FBH-40SF	1/2"	81

## ONE-TOUCH FOR SMOOTH CONNECTION. INTERNAL LOCK MECHANISM FOR SAFETY!

### Features

- Lock mechanism prevents unexpected disconnection after connection. Suitable for intermediate Cupla for hose extensions.
- Simply push the plug into the socket (or socket over plug) for one-touch connection. Excellent handling improves working efficiency.
- Ball bearing type swivel mechanism reduces load on hands and prevents hose twisting. (SNRG model)
- Low pressure loss valve mechanism gives improved flow rate.



### SOCKET



#### FOR HOSE CONNECTION (SH)

Model	Application	Weight (g)
L200-20SH	For 1/4" hose	90
L200-30SH	For 3/8" hose	92
L200-40SH	For 1/2" hose	104



#### FOR FEMALE THREAD CONNECTION (SM)

Model	Application	Weight (g)
L200-20SM	1/4"	89
L200-30SM	3/8"	91
L200-40SM	1/2"	102



#### FOR MALE THREAD CONNECTION (SF)

Model	Application	Weight (g)
L200-20SF	1/4"	94
L200-30SF	3/8"	103
L200-40SF	1/2"	138



#### HOSE WITH SPRING NUT CONNEC (SNRG)

Model	Application	Weight
L200-65SNRG	For ø6.5xø10 hose	125
L200-85SNRG	For ø8.5xø12.5 hose	132

# PURGE PLUG

## Anti-Whip Safety Plug

### UNPLEASANT NOISE ON DISCONNECTION OF CUPLAS AND SPRING BACK ON HOSE ARE PREVENTED!



### Features

- The remaining pressurised air inside the hose is gradually released on disconnection of Cuplas preventing the hose reaction on disconnection.
- Original purging design allows remaining pressurised air exhaust quickly and silently.
- Can be used with reliability, even when the pressure is high or the hose is long.

### PLUG



#### FOR HOSE CONNECTION (PH)

Model	Application	Weight (g)
PV-20PH	For 1/4" hose	59
PV-30PH	For 3/8" hose	62
PV-40PH	For 1/2" hose	76



#### FOR URETHANE HOSE CONNECTION (PN)

Model	Application	Weight (g)
PV-65PN	For ø6.5xø10 hose	71
PV-85PN	For ø8.5xø12.5 hose	78

### Specifications

Body Material	Steel (chrome-plated)	
Working pressure	145 PSI	1.0MPa (10 kgf/cm <sup>2</sup> )
Pressure resistance	215 PSI	1.5MPa (15 kgf/cm <sup>2</sup> )

*Genuine*

# NITTO CUPLA<sup>®</sup>

## BEWARE OF IMITATIONS

SIMILAR PRODUCTS THAT INVITE MISIDENTIFICATION OR CONFUSION WITH NITTO KOHKI CUPLAS, AND PRODUCTS THAT CLAIM TO HAVE COMPATIBLE MATING PARTS, HAVE RECENTLY APPEARED ON THE MARKET.

EVEN IF IT WERE POSSIBLE TO CONNECT A NITTO KOHKI CUPLA WITH A COUPLING OF ANOTHER BRAND, NITTO KOHKI CANNOT ACCEPT RESPONSIBILITY FOR ANY ACCIDENT THAT MAY RESULT.

NITTO KOHKI CUPLAS ARE PRODUCED WITH UNIQUE TOLERANCES AND PRECISION BASED ON STRICT QUALITY CONTROL AND ARE NOT INTERCHANGEABLE WITH COUPLINGS MADE BY OTHERS. THEREFORE, THEIR USE IN CONNECTION WITH ANOTHER BRAND OF COUPLING IS QUITE CAPABLE OF CAUSING SUDDEN DAMAGE TO THE CUPLA OR PERSONAL INJURY.

WHEN ORDERING AND PURCHASING, PLEASE BE SURE TO CHECK THAT THE FOLLOWING MARKS ARE INSCRIBED ON NITTO KOHKI CUPLA PRODUCTS.

IF YOU CAN'T FIND ANY NITTO MARK ON THE PRODUCTS YOU USE, ENQUIRE WITH YOUR SUPPLIER FOR PRODUCT LIABILITY INSURANCE.

